

Schools

Portfolio

As architects, landscape architects and urban designers, we create award winning buildings, living landscapes and thriving urban spaces, using inventive design to solve real life challenges. Each of our projects is different but the driving force behind every one is the desire to create something that is inherently beautiful, sustainable and useful.

Designing buildings for education is an established strand of our portfolio. Our work covers both primary and secondary age groups, including junior schools, sixth form centres, music facilities, teaching accommodation and boarding houses. We also draw on our experience in other sectors such as the arts, where we have expertise in the design of auditoriums.

We also work on extensive, strategic masterplans that offer a creative framework and vision for growth. This helps bring school estates into the 21st Century in terms of evolving educational needs, student experience and environmental excellence. Many of our recent projects have dealt with listed buildings on constrained, sensitive sites. Importantly, we always strike a balance between respecting architectural heritage whilst meeting modern day quality and accessibility standards.

The additional resource of our urban designers and landscape architects enables us to look holistically at all projects, providing the expertise to deal with both the macro scale masterplanning and micro scale detailing. We use a variety of different methods of engagement, ensuring that everyone understands our vision and can contribute their ideas.

Our clients include:

- Withington Girls' School
- Stonyhurst College
- Eltham College
- King's Bruton
- Haberdashers' Monmouth Schools
- Leighton Park School
- Elizabeth College
- St Bede's College
- Queen Margaret's School
- Marymount International School
- King Edward VI High School for Girls
- Blackheath Prep.



"I am absolutely delighted with the new Turberville Building at Eltham College, which will allow us to provide exceptional new facilities for our students as we look to enhance our teaching and learning space before becoming fully co-educational."

Guy Sanderson, Headmaster, Eltham College

The Turberville Building

Bromley, London

Eltham College

Under the College's expansion plans, we have replaced a failing 1960s wing extension with the new Turberville Building; a new central sixth form centre and a variety of departmental teaching, study, seminar and social spaces organised over three storeys. Located adjacent to the listed main school building and forming the fourth side of the re-landscaped historic quad, its design is a modern interpretation of the classical architecture adjacent and responds appropriately to the differing contextual scales on the two opposite sides of the building. A new wellbeing centre, clad in black stained timber, also sits as a modest pavilion in the new landscaped setting.





“The new facilities will transform the learning of our girls in a number of subjects, providing for practical, hands-on activities and giving huge amounts of extra space for girls’ independent learning and social interaction alike.”

Sue Marks, Headmistress, Withington Girls’ School



New Junior School and Communal Hub

Manchester

Withington Girls’ School

In order to provide additional facilities for this growing school, we first provided a masterplan for the estate focusing on reclaiming underused areas. An external courtyard is now a new internal hub encompassing the existing two storey octagonal arts building, which has been kept and a new roof added at first floor level to link it to the surrounding buildings. A new two form entry, 7-11, junior school also infills space providing eight new classrooms, alongside a hall, IT suite, library, staff office, storage rooms and changing areas.







The Queen Elizabeth Music School

Somerset

King's School, Bruton

The new music school at King's School, Bruton, sits on the site of a former open-air swimming pool, amongst a collection of listed buildings dating from the 16th Century. Facilities include a recital hall, peripatetic rooms, practice rooms, music classrooms and a recording studio.

A carefully crafted 'box of tricks', the design has been driven by the constrained but inspiring site and an ambitious client brief. Situated within a rich landscape of historic structures, the setting demanded an architecturally sympathetic response, whilst delivering the complex technical and acoustic requirements of a music school.

"Since the idea of a new music school was first discussed, I hoped the building would transform both our music facilities and an unappealing brownfield site at the centre of our historic campus. The final building is even better than I hoped for... The design, use of light and space as well as the acoustic engineering are all of the highest quality."

Ian Wilmshurst, Headmaster, King's School







Blackheath Prep

Greenwich, London

Blackheath Prep

At Blackheath Prep, which is housed in a Grade II listed Georgian building, we have upgraded the entrance reception, meeting room and senior management offices, whilst remaining sympathetic to the heritage setting. Through partial demolition and a peeling back of since defunct accretive works, we have brought harmony and clarity to the spaces. We have also elevated the main entrance of the school from simply a functional administrative area to an inviting space that celebrates its historic features. The new workspaces are calm and ordered, with individual characters, supporting the school in its endeavour to deliver top quality education in a welcoming environment.



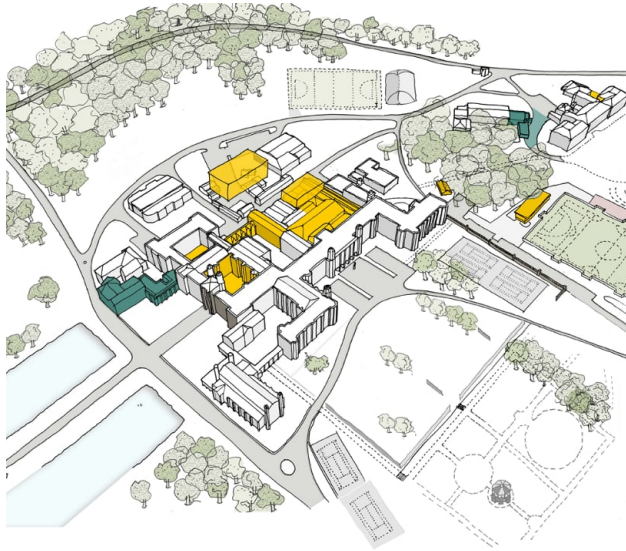

Stonyhurst College Masterplan

Lancashire
Stonyhurst College

Dating from 1593, this historic estate comprises a mix of Grade I, II* and II listed structures and landscape features. Working closely with stakeholders, including staff, governors and Historic England, we have completed a comprehensive strategic masterplan for the site.

Our cohesive vision for the buildings and grounds respects and draws inspiration from the school's rich heritage, whilst identifying opportunities for future development to meet evolving educational needs. Reuse of existing buildings and underused space has been prioritised and supported with new buildings where necessary. We are currently working with the College to deliver the first stages of the masterplan.

“Levitt Bernstein immediately immersed themselves in the culture and history of Stonyhurst. They produced a masterplan which has engaged all the stakeholders and captures every aspect of our estate.”

Simon Marsden, Bursar, Stonyhurst College



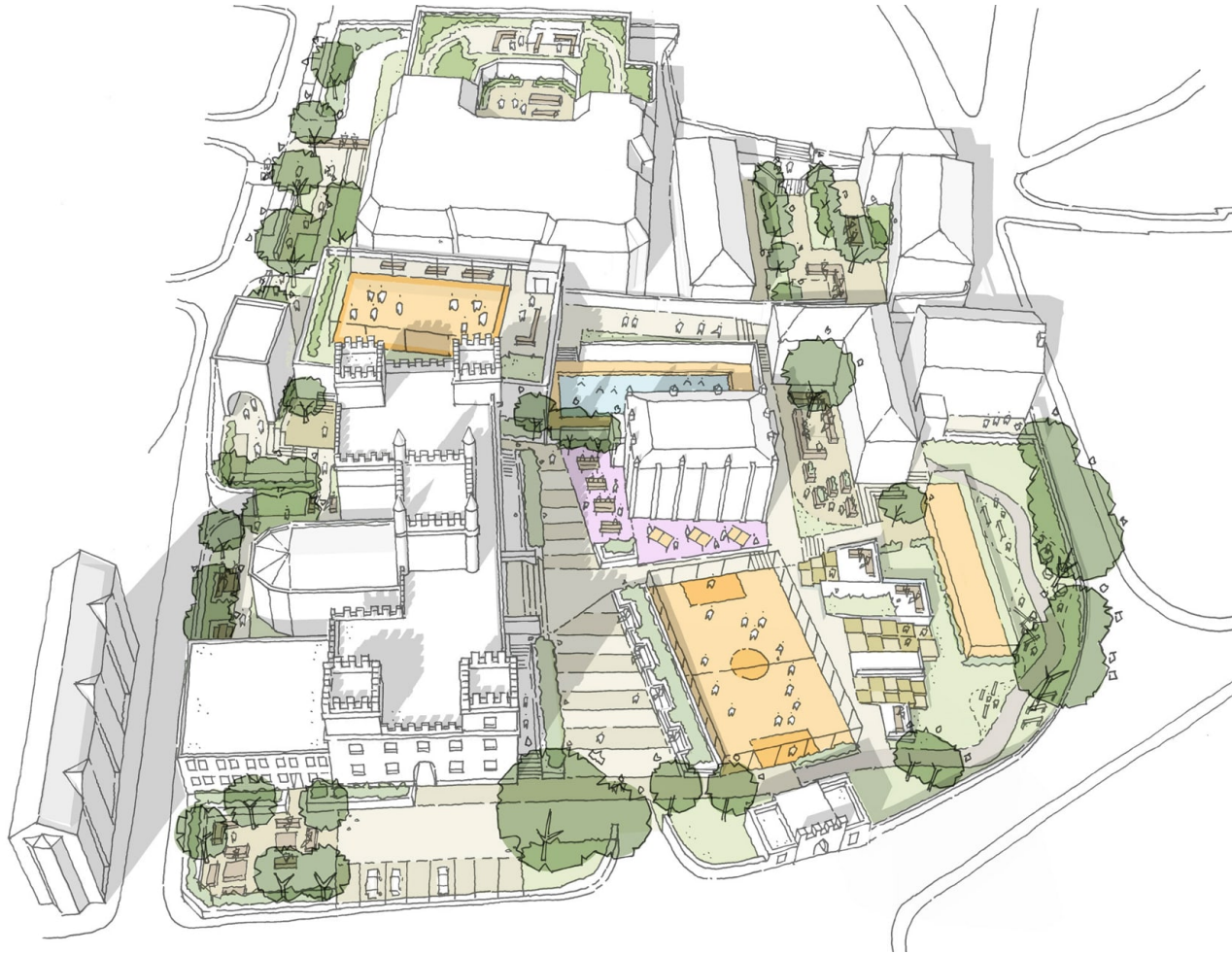

“The masterplan that Levitt Bernstein has produced with and for us has provided a clear route map for the development of an historic, town centre school site. I have very much appreciated their patience, experience, encouragement and creativity.”

Jenny Palmer, Principal, Elizabeth College

Elizabeth College Masterplan

Guernsey
Elizabeth College

We have delivered a masterplan for Elizabeth College that builds on the strength of their reputation, school community and historic setting in St Peter Port. We worked in close partnership with the College to establish a strategic vision for the school's future.

Our comprehensive process of research, wide arching stakeholder consultation and rigorous design resulted in a richly layered proposal considering challenges of all scales. The resultant masterplan features a programme of refurbishment, demolition, new build and significant landscape improvements. Proposals make best use of the estate, including a recently acquired large office building adjacent to the site, whilst modernising facilities through a common vision to prepare for everchanging educational needs.





Leighton Park School Masterplan

Reading

Leighton Park School

Our detailed masterplan for this co-educational boarding school considered all aspects of their large historic estate in the centre of Reading. It included an audit of teaching facilities and focused on best use of existing buildings alongside proposed new build. Consultation with key stakeholders was an integral part of the process to ensure support.

Setting out a framework for development, the masterplan will guide the estate's evolution over the next 30 years. The projects and strategies make best use of the existing site whilst modernising facilities, and a cohesive architectural vision prepares the estate for future educational and boarding needs.

"The masterplan has a very clear narrative and incorporates our recent concerns. The ideas will generate a fair bit of discussion – we feel really uplifted and on a purposeful journey with you."

Matthew Judd, Headmaster, Leighton Park School





“Rather than pupils boarding in vertical houses, at Stonyhurst we group boarders by a horizontal system, or year group. The design of the Old Infirmary fosters this unique family atmosphere.”

Simon Marsden, Bursar, Stonyhurst College

Old Infirmary Boarding House

Lancashire
Stonyhurst College

Following our completion of Stonyhurst College's estate-wide development masterplan, we were commissioned to deliver the first phase; a new boarding house in the Grade II* listed old infirmary building.

The project involved careful internal reworking of this unique building to provide contemporary facilities to meet high-quality boarding demands. The 23 ensuite bedrooms are a mixture of single and twin rooms. Amenities include a house social lounge, two staff flats, kitchen and laundry facilities. The boarding house was designed and delivered within a very short programme to open for the start of the new academic year.





Fryer House, Junior Boarding

Reading

Leighton Park School

A strategic decision at the school to relocate the junior boarders from the current vertical house system to a boarding house of their own has led to the remodelling of the current junior day house. Accommodating 25 boarding spaces for students and associated staff residences, the house is split into boys and girls wings with combined social lounge and kitchen facilities. The dormitories will sleep three to four, with an ensuite shower room in each. The design addresses opportunities for future phased refurbishment, including enclosing the external courtyard to create improved internal social space for both junior day and boarding pupils.

“Since progressing with the refurbishment of Fryer Boarding House, it’s clear the level of quality and finish is just as we hope for here at Leighton Park!”

Matthew Judd, Headmaster, Leighton Park School





Perrot Court, a former office building and car park, enables significant enhancement and extension of the school facilities. The design creates best use of this new space and ensures the remodelled building becomes intrinsically part of the historic school estate. A new bridge link connects the main estate directly into a new double-height circulation core in the new building. Departments include the main school reception, sixth form centre, library, learning support, wellbeing centre, drama, social sciences and administration. Large light slot interventions bring natural light into the heart of the deep plan. Re-landscaping of the historic main building forecourt provides car-free external recreation space for the pupils including a variety of garden, covered seating and hard landscaped areas.



Perrot Court

Guernsey
Elizabeth College





The Performing Arts Centre

Monmouth

Monmouth School for Girls

Enjoying a prominent position above the town of Monmouth in south Wales, this boarding school for girls is on a challenging steep site which includes a Grade II listed main school building.

A new three storey performing arts centre replaces an old gymnasium and links directly to the school's existing main theatre building to provide a centrally located, combined facility for music, drama and dance. Key spaces include an entrance foyer which can be expanded for performance gatherings, a series of peripatetic, group practice and soundproof rooms, a technical studio, music classrooms, a library and new recital hall seating 200 people.



Other brochures

Architecture

Landscape Architecture

Urban Design

Arts

Commercial

Education

Environmental Design

Estate Regeneration

Health

Higher Education

Historic Buildings

Housing

Interior Design

Public Realm

Research

Supported Housing

